



Woods House, 7 Gatliff Road  
London SW1W

GARTON JONES.COM



# Woods House, 7 Gatliff Road London, SW1W

## £600 Per Week

A ONE DOUBLE BEDROOM apartment for rent of approx. 480 sq.ft (44.57 sq.m) in Woods House, one of the buildings forming the popular Grosvenor Waterside development in Chelsea. The apartment has an open plan reception room opening onto a private decked terrace overlooking the communal gardens, a modern kitchen, bathroom and storage including built in wardrobes to the bedroom. 24 HOUR CONCIERGE. On-site Sainsbury's Local, coffee shop and private kids club. SLOANE SQUARE & VICTORIA station with Gatwick Express are within walking distance. Battersea Park is also just a short walk across Chelsea Bridge.

Available via Garton Jones on-site office at Grosvenor Waterside (underneath Bramah House).

\*Please note furniture is different to that shown in the current photos.

EPC Rating: B (82)

Council Tax: Westminster Council (band D).

12 month minimum term. 5 week deposit required.

To check broadband and mobile phone coverage, please visit Ofcom: [ofcom.org.uk/phones-telecoms-and-internet/advice-for-consumers/advice/ofcom-checker](https://www.ofcom.gov.uk/phones-telecoms-and-internet/advice-for-consumers/advice/ofcom-checker)

EPC certificate available on request.

- 480 Sq.ft (44.57 Sq.m)
- 1 Double Bedroom
- Open Plan Reception Room
- Modern Kitchen
- Bathroom
- 24 Hour Concierge
- Private Decked Terrace
- Overlooking Communal Gardens
- On-Site Sainsbury's, Creche, Coffee Shop & Purple Dragon Private Kids Club
- Walking Distance to Sloane Square & Victoria Station

## GARTON JONES.COM

8 Gatliff Road  
Grosvenor  
Waterside  
Chelsea  
London  
SW1W 8DP

Sales +44 (0) 20 7730 5007  
[gws@gartonjones.com](mailto:gws@gartonjones.com)  
[www.gartonjones.com](http://www.gartonjones.com)



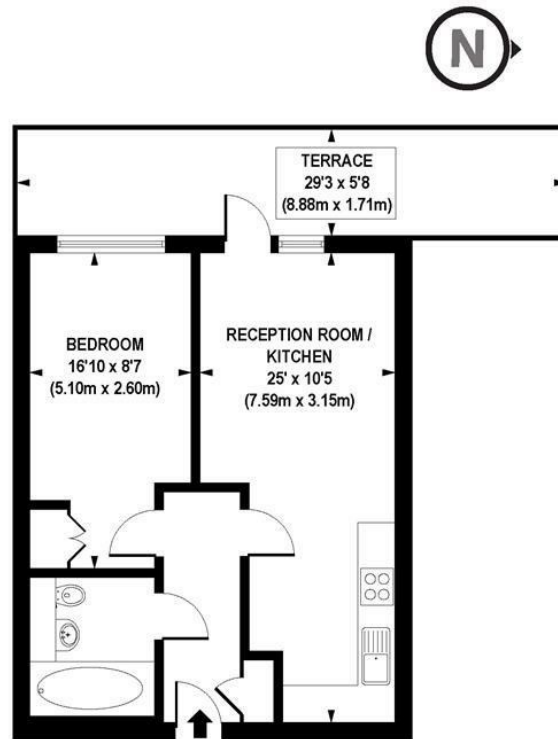

APPROX. GROSS INTERNAL FLOOR AREA 480 sq. ft / 44.57 sq. m

Floorplan is for illustrative purposes only and is not to scale.  
Every attempt has been made to ensure the accuracy of the floorplan shown, however all measurements, fixtures, fittings and data shown are an approximate interpretation for illustrative purposes only.  
Liability for errors, omissions or mis-statement through negligence or otherwise is hereby excluded.

**CP CREATIVE**  
PROPERTY MARKETING



